

G3 formula

Professional Scratch Remover

RESTORE

ELIMINATES LIGHT SCRATCHES OR DIMINISHES THE LOOK OF DEEPER DEFECTS



PRODUCT DESCRIPTION

Using Engineered Abrasive Technology particles, **G3 Pro Scratch Remover** Liquid and Paste permanently remove minor scratch marks that do not stop your fingernail when run over the surface. The appearance of deeper scratches will be diminished. The liquid spreads easily and is ideal for larger areas, whereas the paste is thick and easy to control, making it ideal for small areas. **G3 Pro Scratch Remover** is not for excessive use!

PRODUCT INFORMATION

Size	Part No.	Part No.
150ml	7163	10
500ml	7164	6

TECHNICAL INFORMATION

Appearance: white liquid and paste
 VOC Content: 162g/L (liquid)
 156g/L (paste)
 Relative Density: 1.48 (liquid)
 1.45 (paste)
 pH: 8.8 (liquid and paste)
 Silicones: none

REMOVES SCUFFS AND LIGHT SCRATCHES

EASY APPLICATION BY HAND OR MACHINE

PERMANENT - SILICONE FREE

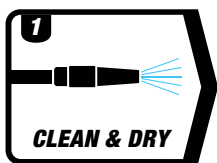

Clean surface thoroughly



Lightly dampen a **G3 Pro White Applicator Waffle Pad**

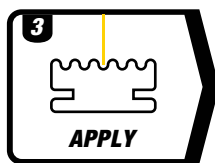

Apply a small amount of the product to the applicator

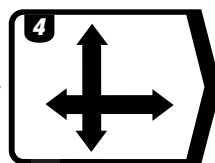

Apply even pressure in a straight back and forth motion starting left to right and then up and down



Wipe with a clean, dry **G3 Pro Super Soft Microfibre Fleece**

Stop once the scratch is removed or if the paint begins to fade. If dulling appears DON'T PANIC! Simply use **G3 Pro Paint Renovator** or **G3 Pro Colour Restorer** with a clean **G3 Pro White Applicator Waffle Pad**. This is most likely on darker paints.



AS USED BY PROFESSIONALS

+44 (0)1920 465 041 | enquiries@farecla.com | www.G3Pro.com